

HARO Sports Floors

Dominating the game.

Protect Pro Plywood covered

Type: Area-elastic Protective Walls
Usage: Sports and multi-purpose facilities

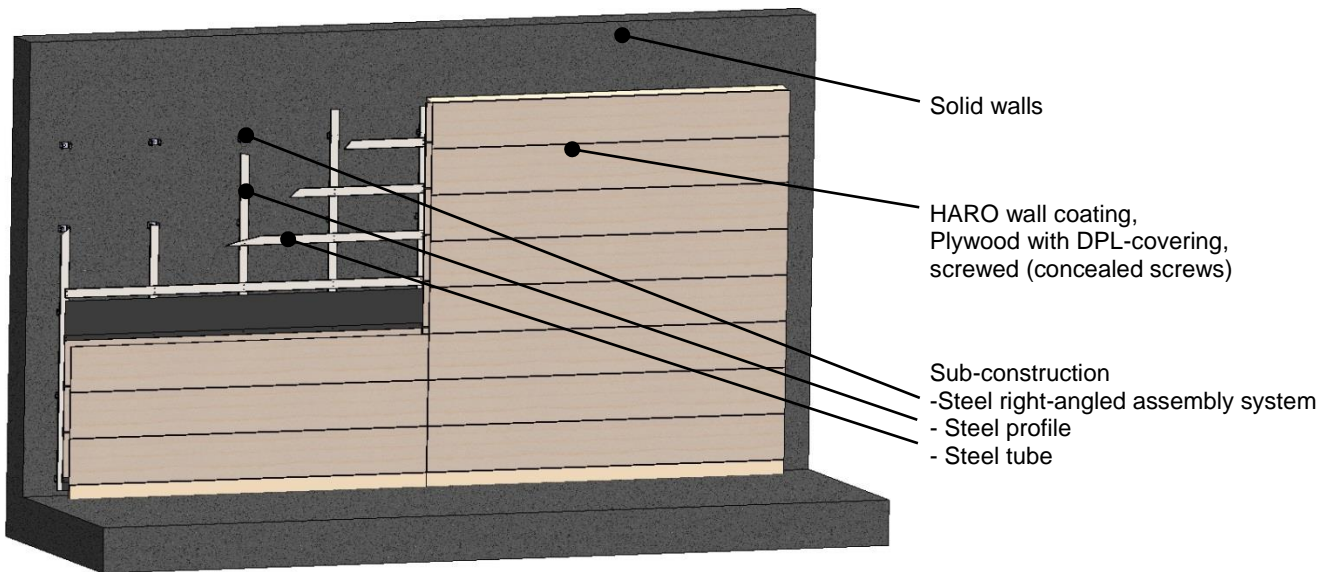

Installation on an even wall surface according to DIN 18202, 1997-04, Chart 3	Model Protect Pro Plywood covered
HARO Optional Sub-construction (only in particular cases) Consisting of wide span supporting elements to increase the wall depth	up to 750 mm
HARO Shock Absorption Sub-construction Consisting of steel compression spring, steel profile and steel rectangular tube	80 mm
HARO wall coating , made of plywood with DPL-covering, sharp edges removed, screwed (concealed screws) Standard length: 1.200 mm Standard width: 500 mm, 1.000 mm, 2.000 mm	20 mm
Construction height	101 mm

PROTECT PRO PLYWOOD COVERED protective walls meet the DIN 18032-1, April 2001, the DIN 18032-3, April 199, the safety information requirements of the Unfallkasse Sachsen _Accident Insurance from Saxony_ (GUV-SI 8468) and the DIN CERTCO certification program for protective walls.

