

## HARO Sports Floors

Dominating the game.

### Protect Classic Spruce VNK

Type: Area-elastic Protective Walls  
Usage: Sports and multi-purpose facilities

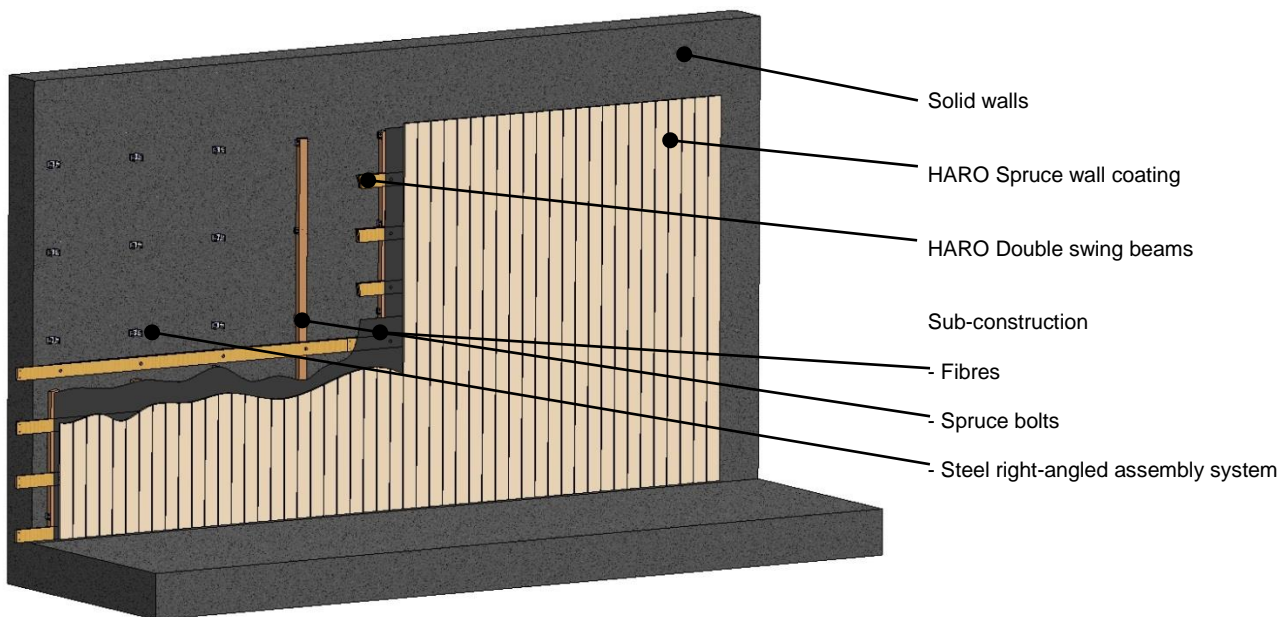

Installation on an even wall surface according to DIN 18202, 1997-04, Chart 3

Model Protect Classic Spruce VNK

#### HARO Sub-construction

Consisting of steel right-angled assembly system with spruce bolts or wood panel modules

up to 750 mm

#### HARO Double swing beams

Made of plywood without elastic pads

39 mm

#### HARO wall coating

Made of Nordic spruce, longitudinal edges 5mm rounded  
Approx. length from 2m to 5m

18 mm

#### Construction height

97 mm

PROTECT CLASSIC SPRUCE VNK protective walls meet the DIN 18032-1, April 2001, the DIN 18032-3, April 199, the safety information requirements of the Unfallkasse Sachsen \_Accident Insurance from Saxony\_ (GUV-SI 8468).

