

## HARO Sports Floors

Dominating the game.

### Protect Classic Spruce

Type: Area-elastic Protective Walls  
Usage: Sports and multi-purpose facilities

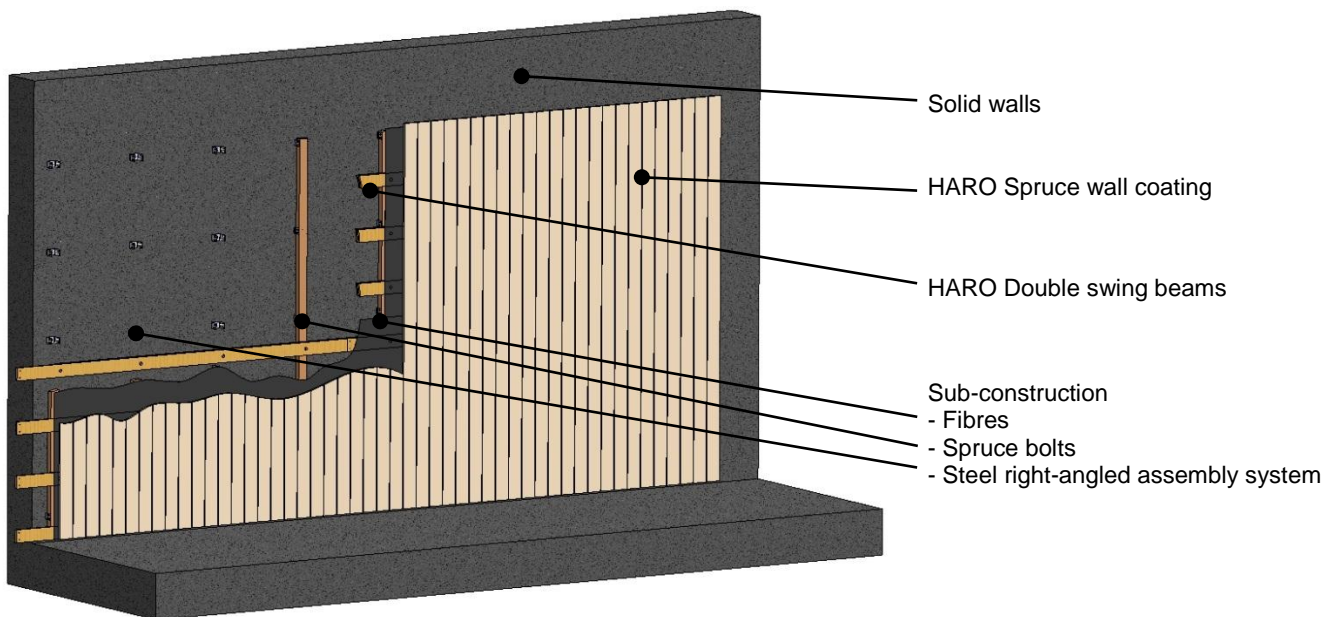

<b>Installation on an even wall surface according to DIN 18202, 1997-04, Chart 3</b>	<b>Model Protect Classic Spruce</b>
<b>HARO Sub-construction</b> Consisting of steel right-angled assembly system with spruce bolts or wood panel modules	up to 750 mm
<b>HARO Double swing beams</b> Made of plywood without elastic pads	39 mm
<b>HARO wall coating</b> Made of Nordic spruce, longitudinal edges 5mm rounded Approx. length from 2m to 5m	18 mm
<b>Construction height</b>	97 mm

PROTECT CLASSIC SPRUCE protective walls meet the DIN 18032-1, April 2001, the DIN 18032-3, April 199, the safety information requirements of the Unfallkasse Sachsen \_Accident Insurance from Saxony\_ (GUV-SI 8468) and the DIN CERTCO certification program for protective walls.

