

HARO Sports Floors

Dominating the game.

Protect Classic Spruce VNK

Type: Area-elastic Protective Walls
Usage: Sports and multi-purpose facilities

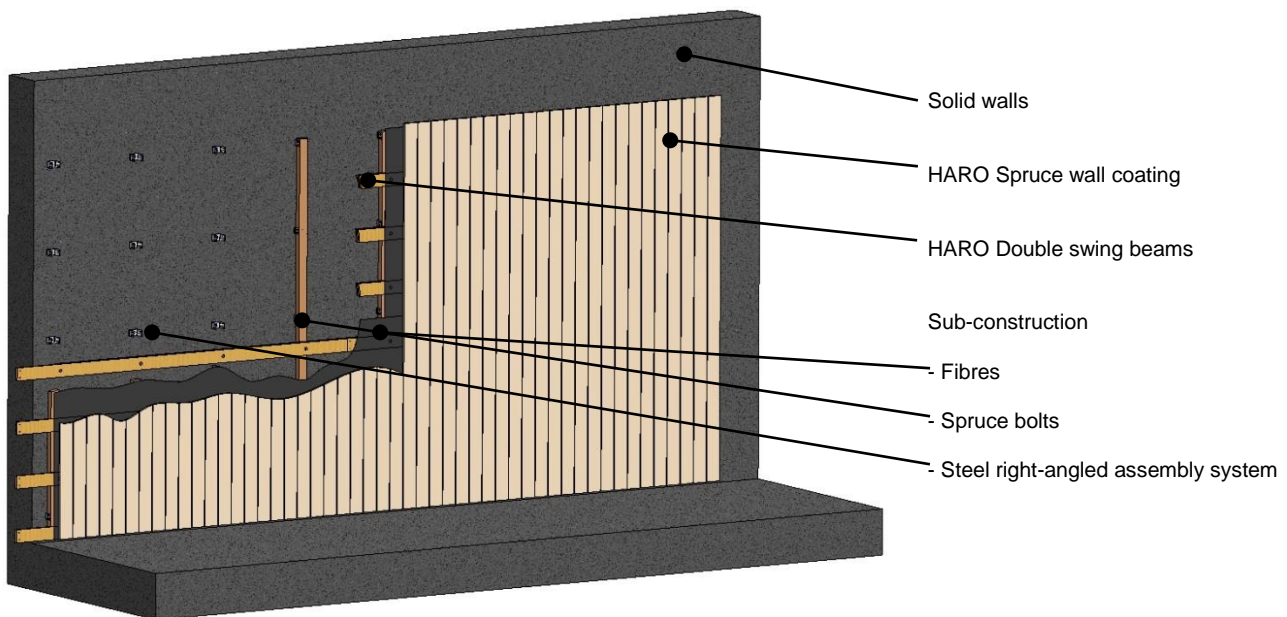

Installation on an even wall surface according to DIN 18202, 1997-04, Chart 3

Model Protect Classic Spruce VNK

HARO Sub-construction

Consisting of steel right-angled assembly system with spruce bolts or wood panel modules

up to 750 mm

HARO Double swing beams

Made of plywood without elastic pads

39 mm

HARO wall coating

Made of Nordic spruce, longitudinal edges 5mm rounded
Approx. length from 2m to 5m

18 mm

Construction height

97 mm

PROTECT CLASSIC SPRUCE VNK protective walls meet the DIN 18032-1, April 2001, the DIN 18032-3, April 199, the safety information requirements of the Unfallkasse Sachsen _Accident Insurance from Saxony_ (GUV-SI 8468).

