

HARO Sports Floors

Dominating the game.

Protect Classic Spruce

Type: Area-elastic Protective Walls
Usage: Sports and multi-purpose facilities

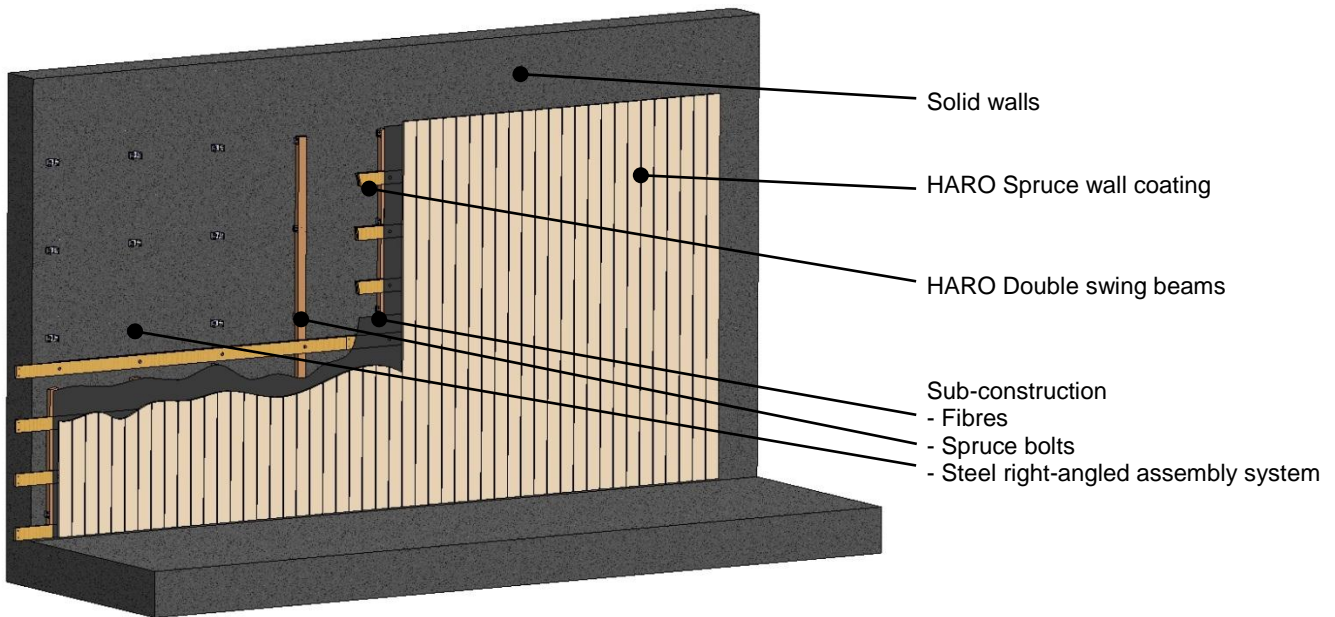

Installation on an even wall surface according to DIN 18202, 1997-04, Chart 3	Model Protect Classic Spruce
HARO Sub-construction Consisting of steel right-angled assembly system with spruce bolts or wood panel modules	up to 750 mm
HARO Double swing beams Made of plywood without elastic pads	39 mm
HARO wall coating Made of Nordic spruce, longitudinal edges 5mm rounded Approx. length from 2m to 5m	18 mm
Construction height	97 mm

PROTECT CLASSIC SPRUCE protective walls meet the DIN 18032-1, April 2001, the DIN 18032-3, April 199, the safety information requirements of the Unfallkasse Sachsen _Accident Insurance from Saxony_ (GUV-SI 8468) and the DIN CERTCO certification program for protective walls.

